

**IMPORTANT HOME OWNER INFORMATION**

# RESTORE™ ACR

## LUXURY WALK-IN BATHTUB

**Installation, Use and Care Guide**



***mansfield***®

**WARNING****INSTALL TO PERMIT ACCESS FOR SERVICING.****INSTALL THIS UNIT IN ACCORDANCE WITH THE LOCAL ELECTRICAL CODE.****(Canadian electrical code, part 1, for Canada).****NOT APPLICABLE IF UNIT IS SUPPLIED WITH AN ELECTRIC PLUG.****DANGER: RISK OF ELECTRICAL SHOCK. (Consult local electrical sub code official).**

Use this unit only for its intended use as described in this manual. Do not use attachments not recommended by the manufacturer. For indoor use only. Grounding is required. The unit should be installed by a qualified service representative and grounded. The unit must be connected only to a supply circuit that is protected by a ground fault circuit interrupter (GFCI ñ class A in Canada). Such a GFCI should be provided by the installer and should be tested on a routine basis. To test the GFCI, push the test button. The GFCI should interrupt power. Push the reset button. Power should be restored. If the GFCI fails to operate in this manner, there is a ground current flowing, indicating the possibility of an electric shock. Do not use this unit, and have the problem corrected by a qualified service representative before using. For permanently connected units, a green colored terminal is provided within the terminal. To reduce the risk of electric shock, connect this terminal or connector to the grounding terminal of your electric service or supply panel with a conductor equivalent in size to the circuit conductors supplying this equipment. This unit has no user serviceable parts. All service must be performed by a qualified service representative. Each accessory is supplied with its own separate operating instructions and must be read, followed and saved. Always consult local codes and/or local sub code official.

**WARNING - IMPORTANT SAFETY INSTRUCTIONS**

1. IMPORTANT SAFETY INSTRUCTIONS and INSTRUCTIONS IMPORTANTES RELATIVES A LA SECURITE.
2. READ AND FOLLOW ALL INSTRUCTIONS and LIRE ET SUIVRE TOUTES LES INSTRUCTIONS.
3. SAVE THESE INSTRUCTIONS and CONSERVER CES INSTRUCTIONS.
4. **⚠ WARNING:** RISK OF ACCIDENTAL INJURY OR DROWNING; CHILDREN SHOULD NOT USE HYDROMASSAGE BATHTUB WITHOUT ADULT SUPERVISION and AVERTISSEMENT. RISQUE DE BLESSURE ET DE NOYADE. NE PAS LAISSER UN ENFANT UTILISER LA CUVE A REMOUS EN L'ABSENCE D'UN ADULTE.
5. **⚠ WARNING:** RISK OF ACCIDENTAL INJURY OR DROWNING; DO NOT USE HYDROMASSAGE BATHTUB UNLESS ALL SUCTION GUARDS ARE INSTALLED TO PREVENT BODY AND HAIR ENTRAPMENT and AVERTISSEMENT. RISQUE DE BLESSURE ET DE NOYADE. POUR EVITER LE HAPPEMENT DE MEMBRES OU DE CHEVEUX, NE PAS UTILISER LA CUVE A REMOUS SI LES PRISES D'ASPIRATION NE SONT PAS TOUTES MUNIES D'UNE GRILLE.
6. **⚠ WARNING:** TO AVOID INJURY, EXERCISE CARE WHEN ENTERING OR EXITING THE HYDROMASSAGE BATHTUB and AVERTISSEMENT. POUR EVITER LES BLESSURES, USER DE PRUDENCE EN ENTRANT DANS LA CUVE A REMOUS ET EN LA QUITTANT.
7. **⚠ WARNING:** RISK OF ACCIDENTAL INJURY OR DROWNING; DO NOT USE DRUGS OR ALCOHOL BEFORE OR DURING THE USE OF A HYDROMASSAGE BATHTUB EQUIPPED WITH HEATER TO AVOID UNCONSCIOUSNESS AND POSSIBLE DROWNING and AVERTISSEMENT. RISQUE DE BLESSURE ET DE NOYADE. NE PAS PRENDRE DE MEDICAMENT NI CONSOMMER D'ALCOOL LORSQU'ON UTILISE UNE CUVE A REMOUS CHAUFFEE OU AVANT D'Y ENTRER AFIN D'EVITER L'EVANOUISSEMENT ET LE RISQUE DE NOYADE.
8. **⚠ WARNING:** RISK OF FETAL INJURY; PREGNANT OR POSSIBLE PREGNANT WOMEN SHOULD CONSULT A PHYSICIAN BEFORE USING A HYDROMASSAGE BATHTUB EQUIPPED WITH HEATER and AVERTISSEMENT. DANGER POUR LE FETUS LES FEMMES ENCEINTES, QUE LEUR GROSSESSE SOIT CONFIRMEE OU NON, DEVRAIENT CONSULTER UN MEDECIN AVANT D'UTILISER UNE CUVE A REMOUS CHAUFFEE.
9. **⚠ WARNING:** RISK OF HYPERTHERMIA AND POSSIBLE DROWNING; DO NOT USE A HYDROMASSAGE BATHTUB EQUIPPED WITH HEATER IMMEDIATELY FOLLOWING STRENUOUS EXERCISE and AVERTISSEMENT. RISQUE D'HYPERTHERMIE ET DE NOYADE. NE PAS UTILISER UNE CUVE A REMOUS CHAUFFEE APRES UN EXERCICE INTENSE. The causes, symptoms, and effects of hyperthermia may be described as follows: Hyperthermia occurs when the internal temperature of the body reaches a level several degrees above the normal body temperature of 98.6°F. They symptoms of hyperthermia include an increase in the internal temperature of the body, dizziness, lethargy, drowsiness and fainting. The effects of hyperthermia include:
  - a. Failure to perceive heat
  - b. Failure to recognize the need to exit the hydromassage bathtub,
  - c. Unawareness of impending hazard,
  - d. Fetal damage in pregnant women,
  - e. Physical inability to exit the hydromassage bathtub, and
  - f. Unconsciousness resulting in the danger of drowning.**⚠ WARNING:** The use of alcohol, drugs, or medication can greatly increase the risk of fatal hyperthermia.
10. **⚠ WARNING:** RISK OF ELECTRIC SHOCK; DO NOT PERMIT ELECTRIC APPLIANCES (SUCH AS A HAIR DRYER, LAMP, TELEPHONE, RADIO OR TELEVISION) WITHIN 5 FEET OR 1.5 M OF THIS HYDROMASSAGE BATHTUB; AVERTISSEMENT. RISQUE DE CHOC ELECTRIQUE. NE PAS PLACER D'APPAREILS ELECTRIQUES (LUMINAIRE, TELEPHONE, RADIO, TELEVISEUR, ETC.). A MOINS DE 1,5 M DE CETTE CUVE A REMOUS.
11. **⚠ CAUTION:** TEST THE GROUND FAULT CIRCUIT INTERRUPTER PROTECTING THIS APPLIANCE PERIODICALLY IN ACCORDANCE WITH THE MANUFACTURER'S INSTRUCTIONS and ATTENTION. VERIFIER REGULIEREMENT LE FONCTIONNEMENT DU DISJONCTEUR DE FUITE A LA TERRE CONFORMEMENT AUX INSTRUCTIONS DU FABRICANT.

# IMPORTANT SAFETY INSTRUCTIONS CONTINUED

12. **⚠ WARNING:** RISK OF HYPERTHERMIA AND POSSIBLE DROWNING; WATER TEMPERATURE IN EXCESS OF 104°F or 38°C MAY BE INJURIOUS TO YOUR HEALTH. CHECK AND ADJUST WATER TEMPERATURE BEFORE USE and AVERTISSEMENT. RISQUE D'HYPERTHERMIE ET DE NOYADE. UNE TEMPERATURE D'EAU SUPERIEURE A 38° C PEUT PRESENTER UN RISQUE POUR LA SANTE. VERIFIER ET REGLER LA TEMPERATURE DE L'EAU AVANT D'UTILISER LA CUVE.
13. **⚠ WARNING:** RISK OF HYPERTHERMIA; PEOPLE USING MEDICATION AND/OR HAVING AN ADVERSE MEDICAL HISTORY SHOULD CONSULT A PHYSICIAN BEFORE USING A HYDROMASSAGE BATHTUB EQUIPPED WITH HEATER and AVERTISSEMENT. RISQUE D'HYPERTHERMIE. LES PERSONNES QUI PRENNENT DES MEDICAMENTS OU QUI ONT DES PROBLEMES DE SANTE DEVRAIENT CONSULTER UN MEDECIN AVANT D'UTILISER UNE CUVE A REMOUS CHAUFFEE.
14. IN CANADA: INSTALL THIS UNIT IN ACCORDANCE WITH THE CANADIAN ELECTRICAL CODE, PART I. and INSTALLER CONFORMEMENT AU CODE CANADIEN DE L'ELECTRICITE, PREMIERE PARTIE.
15. DO NOT DROP OR INSERT ANY FOREIGN OBJECT INTO ANY OPENING.
16. DO NOT DISCONNECT, ALTER OR TAMPER WITH ANY ELECTRICAL WIRING. SERVICE MUST BE PERFORMED BY A LICENSED ELECTRICIAN OR FACTORY AUTHORIZED PERSON. POWER MUST BE OFF AT THE SOURCE PRIOR TO ANY ELECTRICAL WORK.
17. EACH PUMP/MOTOR, BLOWER AND INLINE HEATER MUST BE CONNECTED TO A DEDICATED GFCI. THE CIRCUITS ARE PROVIDED BY THE LICENSED ELECTRICIAN AND SHOULD BE TESTED ON A ROUTINE BASIS. TO TEST THE GFCI, PUSH THE TEST BUTTON; THE GFCI SHOULD INTERRUPT POWER. PUSH THE RESET BUTTON; POWER SHOULD BE RESTORED. IF THE GFCI FAILS TO OPERATE IN THIS MANNER, THERE IS A GROUND CURRENT FLOWING INDICATING THE POSSIBILITY OF AN ELECTRICAL SHOCK. DO NOT USE THIS UNIT. DISCONNECT THE UNIT AND HAVE THE PROBLEM CORRECTED BY A QUALIFIED SERVICE REPRESENTATIVE BEFORE USING.
18. ALL UNITS NEED A NEMA PLUG TO BE PLUGGED INTO A WALL OUTLET THAT IS CONNECTED TO A BUILT-IN GFCI CIRCUIT BREAKER AND MUST BE CONNECTED TO A SEPARATE CIRCUIT WITH A 20 AMP BREAKER RUN DIRECTLY FROM BREAKER PANEL BOX (15 AMP FOR CANADA).
19. TUB BOTTOM MUST REMAIN CLEAN TO MINIMIZE SLIPPAGE.
20. SOAKING TOO LONG MAKES SOME PEOPLE NAUSEOUS, DIZZY, LIGHT HEADED OR FAINT. DON'T SOAK FOR MORE THAN 15 MINUTES IN 104° FAHRENHEIT WATER. IF YOU WISH TO SOAK FOR A LONGER PERIOD OF TIME IN HIGH TEMPERATURES, LEAVE THE TUB FOR 15 MINUTES, SHOWER, COOL DOWN AND THEN RETURN FOR ANOTHER BRIEF STAY. IN LOWER TEMPERATURES (e.g., 98.6° - normal body temperature), MOST PEOPLE CAN COMFORTABLY AND SAFELY SOAK FOR LONGER PERIODS. IF YOU HAVE ANY QUESTIONS ABOUT WHAT'S RIGHT FOR YOU AND YOUR FAMILY, CONSULT YOUR DOCTOR).
21. ALL UNITS MUST BE WATER-TESTED FOR LEAKS BEFORE INSTALLATION.
22. ALL WALK-IN TUBS MUST BE INSTALLED WITH A THERMOSTATIC MIXING VALVE, WHICH SHOULD BE SUPPLIED AND INSTALLED BY YOUR PLUMBER.
23. MANSFIELD PLUMBING PRODUCTS, LLC, ACCEPTS NO RESPONSIBILITY FOR ANY INJURIES, BURNS, SCALDS OR SIMILAR OCCURRENCES.
24. USE THIS UNIT ONLY FOR ITS INTENDED PURPOSES OR AS DESCRIBED IN THIS MANUAL. ONLY USE ATTACHMENTS RECOMMENDED BY THE MANUFACTURER.
25. PLEASE NOTE THAT ALL LOCAL ELECTRICAL CODES SHALL BE FOLLOWED FIRST AND FOREMOST.

**SAVE THIS MANUAL: RETAIN FOR CONSUMER USE.**

## GENERAL INFORMATION

Read these instructions completely before installing the product.

You must follow all instructions in this manual. Failure to do so will result in your acceptance of any liability that may occur. Failure to comply with all instructions can result in product and personal injury.

## RESPONSIBILITY OF THE INSTALLER

The installer must inspect and water-test the product prior to installation to ensure the unit is free of defect or damage. In the event of a problem, the unit must not be installed. If the crate or product has been damaged, please call 877-850-3060 immediately.

This product is designed to be installed by a licensed trades person.

Licensed plumbers and electricians should be employed to ensure proper installation. Installers assume all liability for the correct installation procedures.

## IMPORTANT SAFETY INSTRUCTIONS:

**WARNING!** WHEN USING THIS PRODUCT, BASIC PRECAUTIONS SHOULD ALWAYS BE FOLLOWED. READ AND FOLLOW ALL INSTRUCTIONS PERTAINING TO RISK OF FIRE, ELECTRIC SHOCK OR INJURY TO PERSONS.

**DANGER:** TO REDUCE THE RISK OF INJURY, DO NOT PERMIT CHILDREN TO USE THIS PRODUCT UNLESS THEY ARE CLOSELY SUPERVISED AT ALL TIMES.

# UNPACKING THE WALK-IN TUB

NOTE: UPON DELIVERY THE CUSTOMER MUST NOTE ANY APPARENT OUTER CARTON DAMAGE ON THE DRIVER'S PAPERWORK.

BEFORE UNPACKING, THE INSTALLER SHOULD CAREFULLY INSPECT THE OUTER CARTON AND WOOD CRATE FRAME FOR DAMAGE.

THE INSTALLER SHOULD IMMEDIATELY NOTIFY THE DELIVERY COMPANY AND THE SUPPLYING DEALER IF ANY APPARENT OUTER CARTON DAMAGE IS FOUND.

OPEN OUTER PACKING BOX VIA THE TOP AND SIDES AND REMOVE THE BATH FROM ITS PACKAGING, CAREFULLY INSPECT BATH AND REPORT ANY ACTUAL DAMAGE IMMEDIATELY TO YOUR SUPPLYING DEALER AND THE DELIVERY COMPANY.

ONLY LIFT AND MOVE THE BATH AS PROPERLY DIRECTED.

DO NOT LIFT THE BATH OUT OF ITS SHIPPING PACKAGING BY ANY PLUMBING FIXTURES OR ELECTRICAL COMPONENTS.

DO NOT DRAG BATH; DO NOT TILT BATH OR PLACE ON AN ANGLE WITH ALL THE WEIGHT SUPPORTED BY ONLY TWO LEGS.

CAREFULLY PLACE THE BATH ON A LEVEL FLOOR SURFACE.

FAILURE TO COMPLY WITH ANY OF THE ABOVE MAY VOID THE BATH'S WARRANTY.

## PRIOR TO INSTALLING THE WALK-IN BATH

**IMPORTANT NOTE:** Installer must read and follow all instructions in this Installation Guide. Failure to do so may void the warranty.

**IMPORTANT NOTE:** It is the installer's responsibility to obtain all required governmental licences and permits. Any liability for the failure to do so will solely be borne by the installer.

**IMPORTANT NOTE:** Immediately after removing the walk-in bath from its crating and packaging, inspect all electrical and plumbing fittings and, except for the door fittings and door hinge, tighten (do not overtighten) all loose connections as appropriate. Do not alter the door fittings, tamper with the hinge or try to get a closer fit on the seal. DO NOT OVERTIGHTEN ANY BOLTS. The baths are completely water tested prior to leaving the factory and all the door tolerances and clearances are factory set.

TAMPERING WITH THE HINGE OR DOOR SEAL WILL VOID THE WARRANTY.

# TESTING THE WALK-IN TUB

## TEST YOUR WALK-IN TUB BEFORE INSTALLATION

All Mansfield walk-in-tubs are 100% water-tested at the factory and certified to be free of leaks. Transportation and mishandling may cause leaks. It is necessary to test the bath while there is access to all sides of the bath.

1. This unit should be both static and operationally tested with water. It is best to test the unit outside by filling with a garden hose.
2. Place the tub on a completely flat surface in an area where it may be drained after testing.
3. Close the drain and fill the tub until it is up to normal water height level and at least 2" above the highest jet.
4. Allow the water to stand in tub for 30 minutes and then inspect all plumbing and seals for leaks.
5. If tub is jetted, supply electric to unit and run for 10 minutes and inspect for leaks. Inspect the unions around the pump. If a leak is detected hand tighten the unions and ensure that the O-ring is seated properly.
6. Ensure all jets are open and working.

NOTE: If the pump or blower does not activate, check the breaker to ensure power is on and the cable connecting the controls to the pump is attached.

Do not run any pumps or heaters unless the tub is filled with water to proper level. Damage due to dry running pumps is not covered under warranty.

Failure to perform these tests before installation will make the installer liable for future repair costs.

# LEVELING THE WALK-IN TUB

## BEFORE Installing the Walk-in Bathtub

1. Check the floor area where the tub is to be installed.
  - (a) Clean area of any debris or trash.
  - (b) Use a 5' or 6' level and determine if the floor is level. If the floor is not level, adjust all levelling feet to perfectly level the tub. Note: It is important that all levelling feet are completely touching the floor and level. You may find you have to adjust the middle legs lower then the others to slightly raise up the middle of the bath for the door system to work properly.
2. Check to ensure that the drain rough has been placed at the proper location.
3. Ensure that the proper electrical service has been installed at the pump location. See electrical requirements below.

## ELECTRICAL REQUIREMENTS

### ELECTRICAL REQUIREMENTS

Equipment utilized on these baths requires individual dedicated electrical service.

Air Bath (8490 and 8590) – One dedicated 120 volt, 15 amp GFCI protected circuit.

Whirlpool (8090 and 8190) - Two separate dedicated 120 volt, 20 amp GFCI protected circuits (15 amp for Canada).

Combination (8690 and 8790) - Two separate dedicated 120 volt, 20 amp GFCI protected circuits (15 amp for Canada).

MicroDerm (8890 and 8990) - One dedicated 120 volt, 15 amp GFCI protected circuit.

Service must be a dedicated 15 amp, 120 volt service that is GFCI protected.

### ELECTRICAL INSTALLATION

All electrical connections must be carried out by a certified electrician in accordance with local electrical requirements and codes.

## REQUIRED ELECTRICAL RECEPTACLES FOR CANADA

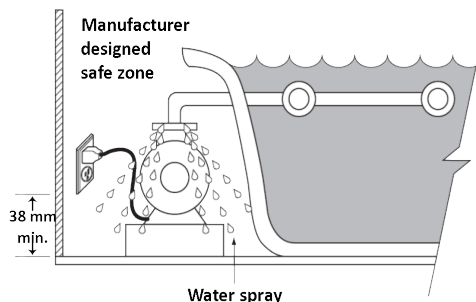

Exclusion zone - Side view

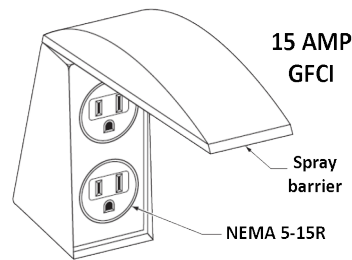

Spray barrier

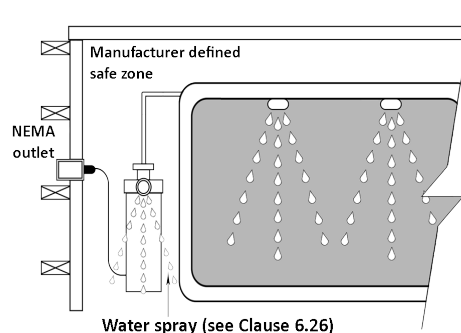

Exclusion zone - Top view



# INSTALLATION INSTRUCTIONS

**▲WARNING:** When using electrical products, basic precautions should always be followed, including the following:

1. **DANGER: RISK OF ELECTRIC SHOCK.** Connect only to a circuit protected by a ground-fault circuit-interrupter.
2. Grounding is required. The unit should be installed by a qualified service representative and grounded.

**With a measuring tape ensure the bath will fit through all passageways and doors.**

1. Remove the existing bath or shower.
2. Check the area where the walk-in bath will be installed for floor integrity. Keep in mind that the walk-in bath is held up by six heavy duty support leveling legs and not the bath's frame.
3. With at least two people, lift the bath by placing hands underneath the deck and carry it to the place of installation. **DO NOT** lift the bath by the plumbing nor the electrical components.
4. Level the walk-in bath from the highest elevation point on the floor. Important note: If the floor is sloping or bowed in any way, work from the highest elevation point using side panels as a guide to the height. Make certain that the tub can be properly leveled. (Caution: if walk-in bathtub is not resting on all leveling feet, water will not drain properly and may cause the door to leak). Verify the product is completely level by checking tub deck surface and ensure all leveling feet are touching the ground.
5. If the product is a whirlpool or an air bath carry out any electrical work that may be required. Make the electrical connections per current regulations, per aforementioned electrical requirements and with a qualified electrician.
6. It is important to ensure that there is no movement in the floor of the intended position as this could cause the door to leak. Therefore, wall brackets are supplied and should be installed as follows:
  - a). Mark the wall to accept the metal wall brackets by placing the bracket against the wall, approximately two (2) inches from each corner of the tub top edge.
  - b). Drill the wall and fit the metal brackets (supplied) to the wall.
  - c). Check walls for square and note any discrepancies. These must be overcome by acceptable methods of filling. The tub will drop approximately 1/4" when filled with water, and allowance should be made for this.
7. With the tub in position, draw a vertical line directly under the corners of the tub where it is touching the walls. These lines will be used for working out the position of the wooden cleats to support the tub panels when they are placed into position.
8. After leveling and **BEFORE** attaching the plumbing to the walk-in bath, **ALL** panels must be temporarily installed to ensure adequate clearance from the floor. Once this has been verified, remove the panels and store in a safe location where they can lay flat until required for installation.
9. Determine the desired faucet location. In most cases the faucet is installed on the deck adjacent to the waste and overflow.

# INSTALLATION INSTRUCTIONS

***Important note: Under no circumstances should you use a cutter that may damage the walk-in bath outside of the cutting area. Doing so will void the warranty.***

10. Measure and verify the span of the faucet assembly's supply lines. Mark position of the holes for the faucets and ensure that your pipe work will not be obstructed by the walk-in bath's steel frame. Double check all measurements.
11. Drill holes for faucets using correct size hole saw being very careful not to damage the outside perimeter of the cutting area.
12. Install the faucets per the faucet manufacturer's instructions. Important note: Under no circumstances should any oil based sealants or jointing compounds be used on any part of the walk-in bath. Doing so will void the warranty.
13. Install the waste and overflow per the waste and overflow instructions inside the box.
14. If any additional fixtures i.e. grab rails, shower attachments, etc., are required, install now per manufacturer's instructions.
15. Check the bath again to make sure it is level.
16. Make necessary connections for the water supply. Make sure your plumber installs a thermostatic mixing valve (TMV) Not Supplied. Connect the hot and cold water supplies to the thermostatic mixing valve. Next connect the mixed hot water outlet from the hot water thermostat to the hot side of the faucet. Connect the cold outlet to the cold side of the faucet. Adjust the thermostat to provide the required temperature desired or to comply with any regulations.
17. Make necessary connections for the waste.
18. Water test and check the piping for leaks.
19. Ensure that the door seal is clean and free from dust.

***Important note: Do not alter the door fittings, tamper with the hinge or try to get a closer fit on the seal. The baths are completely water-tested prior to leaving the factory and all the tolerances and clearances are factory-set. Tampering with the hinge or door seal will void the warranty.***

20. Close the door and fill the walk-in bath to the maximum level and let the filled bath stand for 20 minutes.
21. Check all joints, seals, piping and connections to ensure no leaks.
22. Drain the walk-in bath.
23. Apply a thin bead of silicone sealant between the walk-in bath and the wall and ensure that any excess sealant is removed.

***Important note: Do not use any solvent-based adhesives as these will damage the walk-in bath and will void the warranty.***

# PANEL INSTALLATION

1. For ease of product installation, the main front panel of the tub is attached to the frame where it cannot be easily removed. To access product components and underneath the tub, there are access panels that are attached to the main front panel with magnets. These access panels are easily removed by using a non-sharp object to gently pry the panel from where it is magnetically attached.
2. One end panel is provided with the Walk-in bath. It can be installed on either end as required by the layout of the bathroom. Attach the tub panels using the magnets by sliding the panel upward to match the top edge of the tub. Seal the panels to the tub and apply a finishing seal around the creases of the tub with suitable caulking or silicone sealant.
3. ETL, CSA, IAPMO and UL require a tile flange to be installed in accordance with local building codes. The tile flange kit is sold as an option.



# EXTENSION BOX INSTALLATION

1. The extension box is cosmetic and is designed to cover a frame and give the appearance of an extension of the tub.
2. Follow the detailed installation instructions provided with the extension box kit.

# DOOR DRAIN INSTALLATION

1. Install Drain fitting and Drain shoe according to manufacturer's instructions.
2. Glue Door drain coupler to Drain shoe with PVC Cement Glue leaving the Tubing barb in a horizontal position pointing toward the door side. Note: Before attaching the tubing to the drain make sure the barb coupler is clear with no obstruction.
3. Gauge the length of the pre-installed tubing from the Door drain required to attach to the coupler barb.
4. Attach tubing to barb.
5. Proceed with Waste and Overflow Installation.

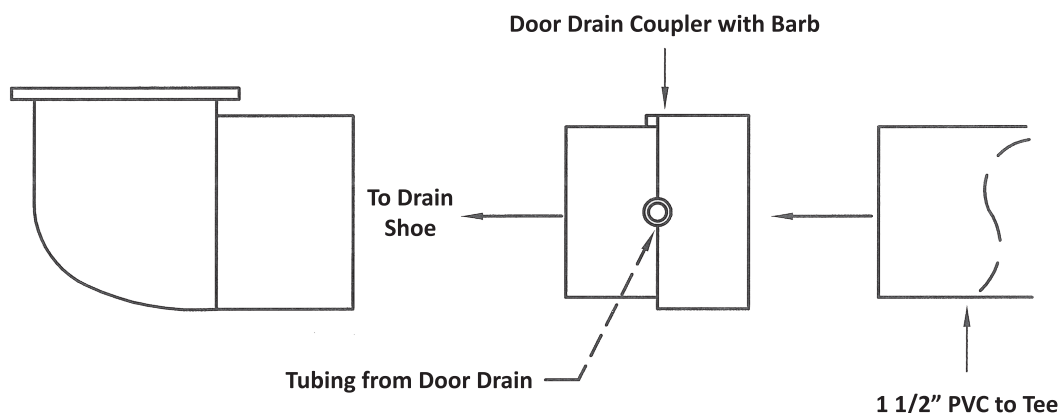



# ELECTRICAL WIRING DIAGRAMS

## DUAL LOAD CONTROL

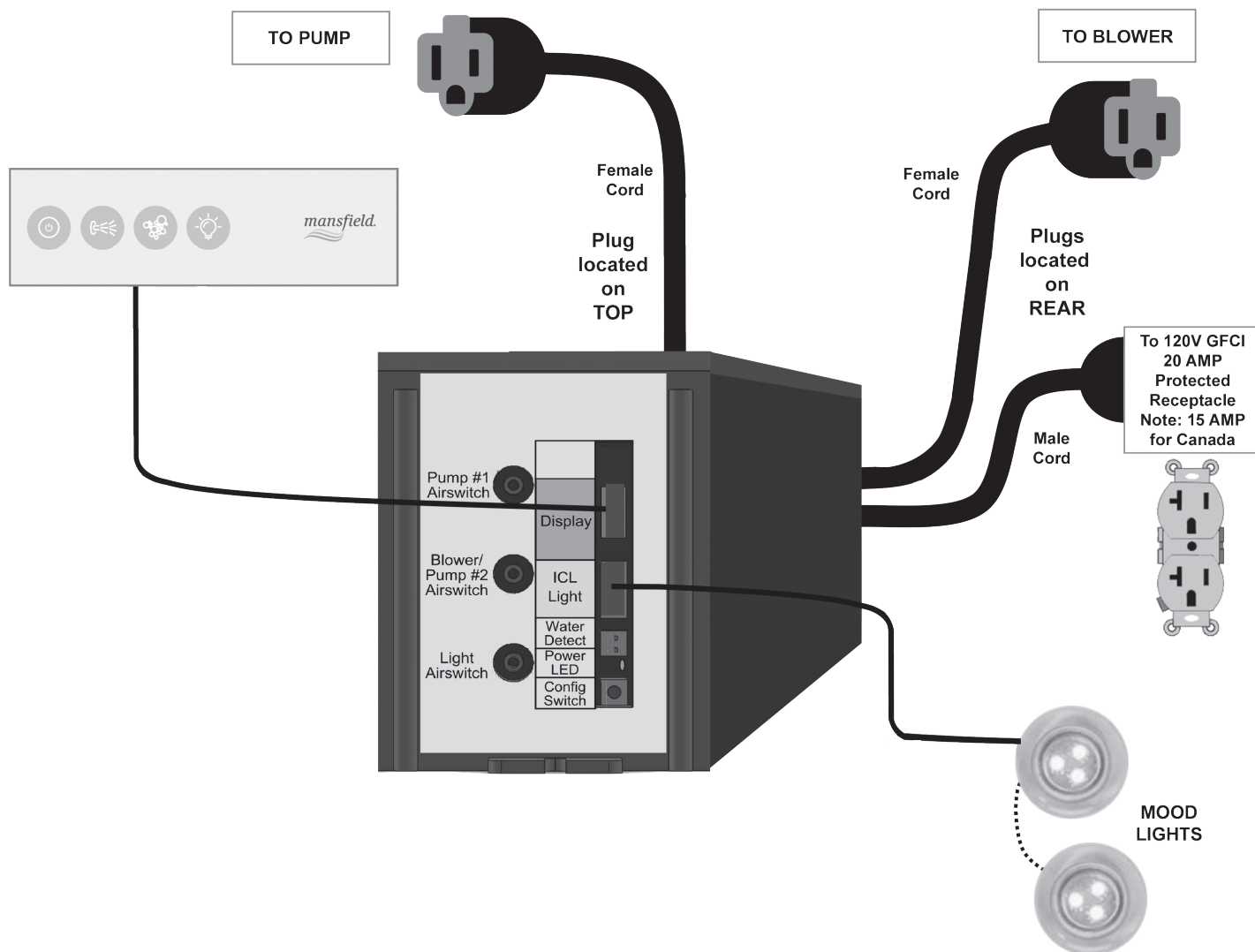

**MODELS: 8090, 8190, 8490, 8590, 8690 and 8790 WITHOUT SURFACE HEATERS**

# ELECTRICAL WIRING DIAGRAMS

## MASTER BATH CONTROL

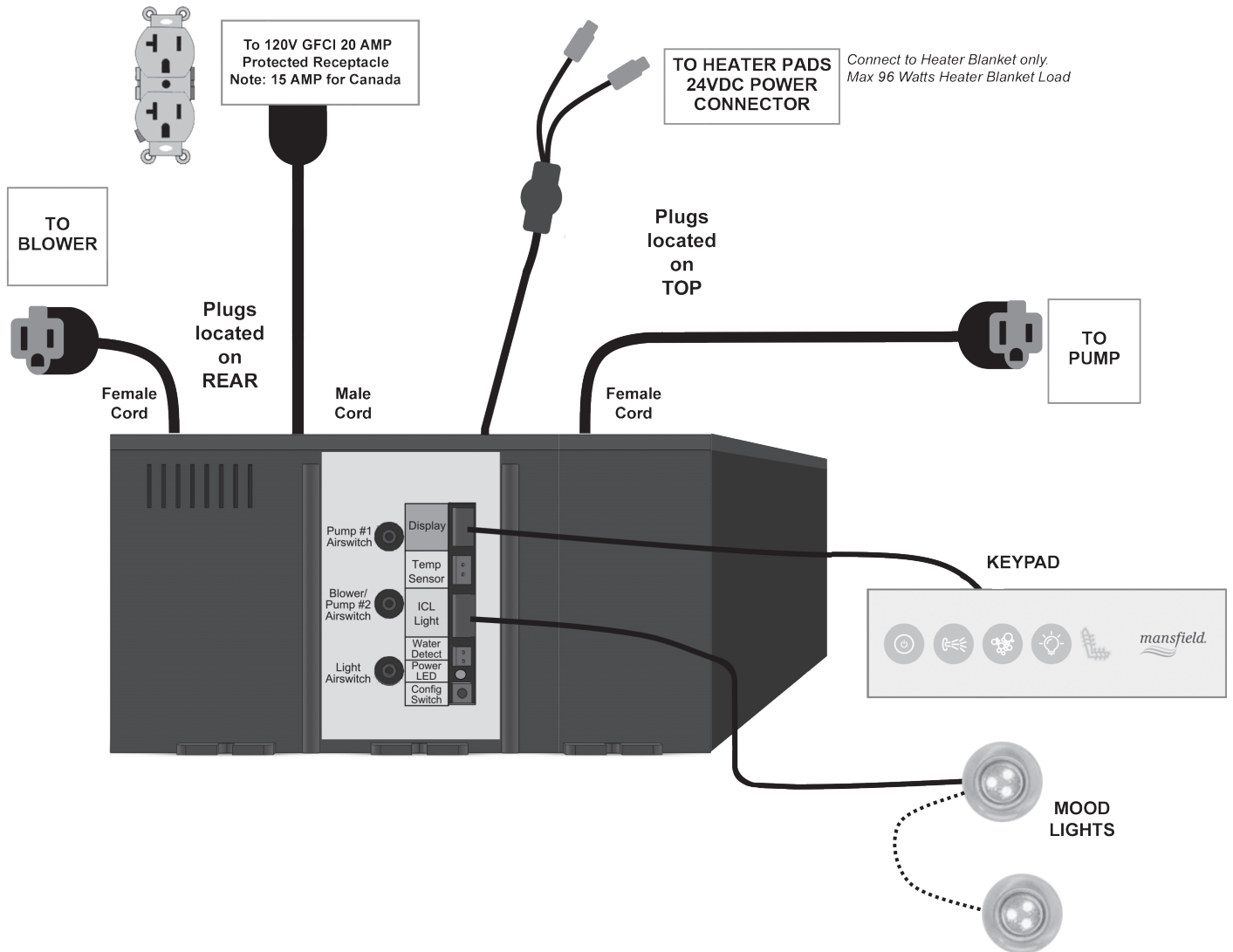

**MODELS: 8090, 8190, 8490, 8590, 8690 and 8790 WITH SURFACE HEATERS**

# ELECTRICAL WIRING DIAGRAMS

## INLINE HEATER AND OZONATOR

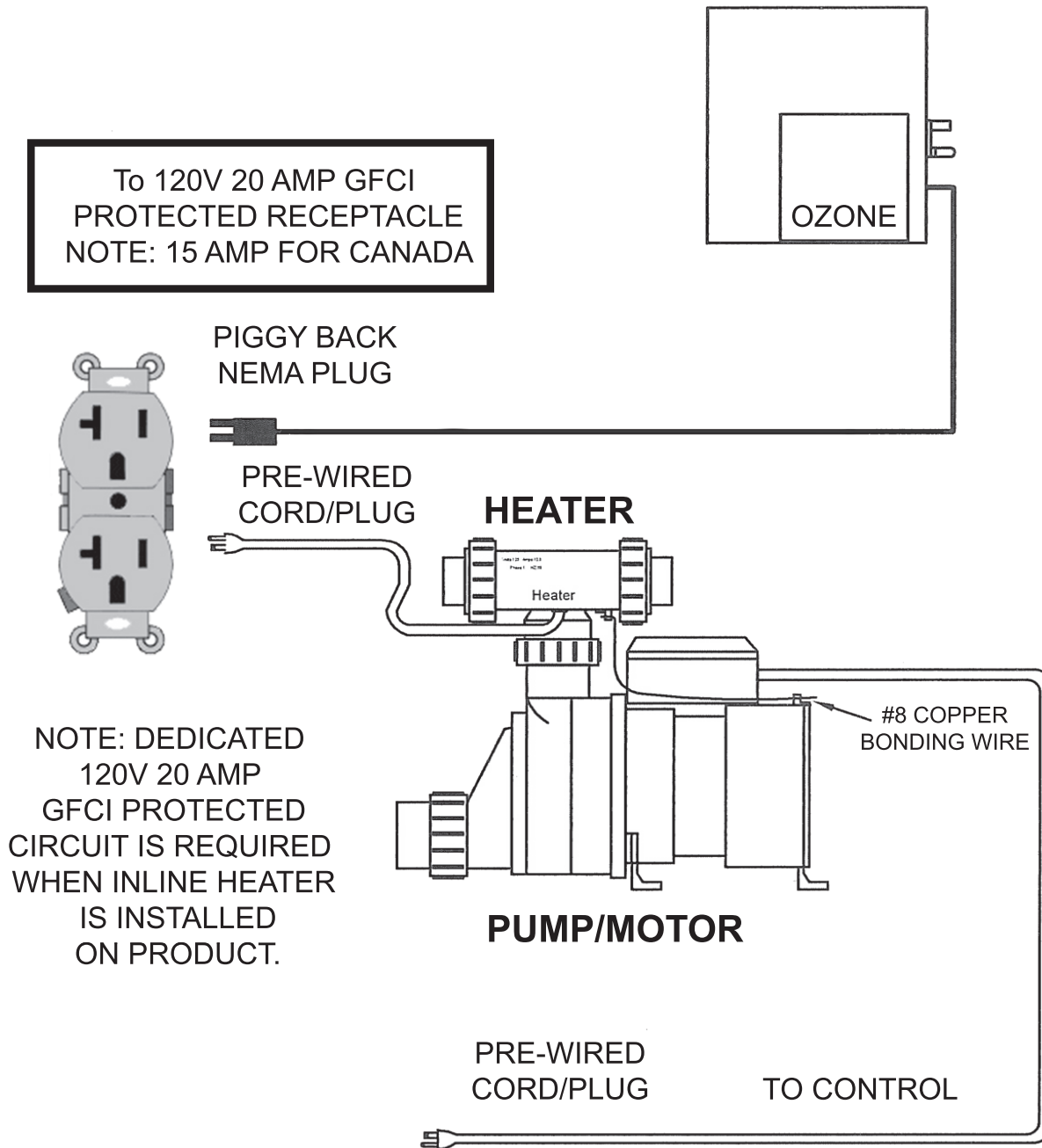

**MODELS: 8090, 8190, 8690 and 8790**

# ELECTRICAL WIRING DIAGRAMS

## MICRODERM THERAPEUTIC BATH

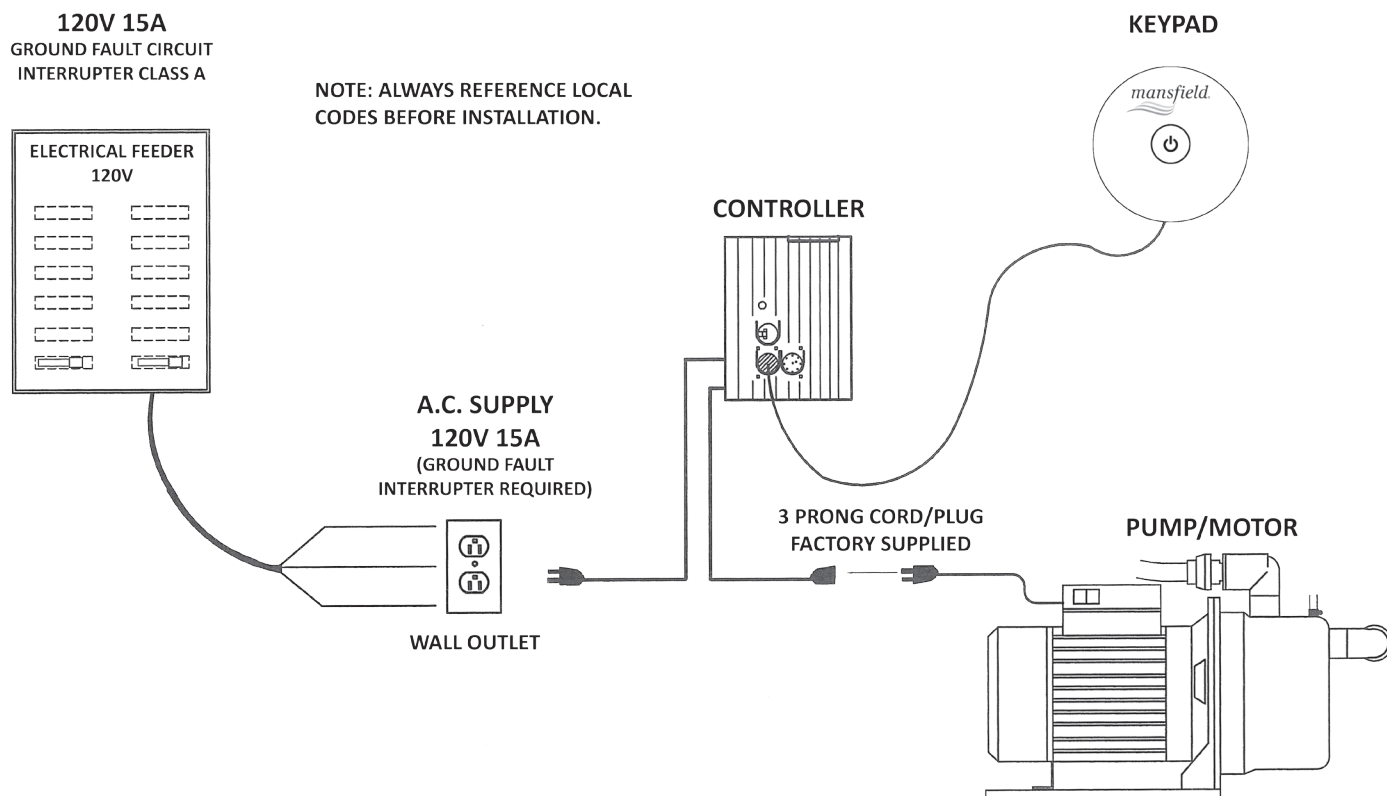

**MODELS: 8890 and 8990**

# USE AND CARE GUIDE

**CHECK THE WATER WHEN YOU BEGIN FILLING TO ENSURE IT IS AT A SAFE TEMPERATURE.**

Congratulations on the purchase of your new walk-in tub. By carefully following your new walk-in tub's instructions, you can benefit from the safety, dignity, independence and a tremendously improved quality of life.

Please read the following instructions before using your walk-in bath and retain for future reference.

## **Proper door handle use:**

Even though the handle is fabricated from the strongest materials available it will not withstand use of excessive force to close the door or use as a grab bar. If used in either of these ways the bottom of the handle may break away from its fixing. The handle is designed as an opening and closing mechanism for the door.

## **Using your Walk-in Tub**

### **RESTORE ACR General Instructions**

Enter the bath and sit if desired. Next, close the door and seal it by pushing the handle forward into the locked position. Close the drain by turning the handle at the overflow counter clockwise. With the pre-set thermostatic mixing valve (professionally installed by your plumber) it is only necessary to turn on the hot water. However, if a cooler bath is desired, turn on the cold water to mix with the hot water. Fill the bath to a depth to best suit your needs. When the bather is done, drain the bath by turning the handle clockwise. After the bath is fully drained, open the door by pulling backward on the door handle and carefully exit the tub.

### **RESTORE Air Bath – Model 8490 or 8590**

#### **IMPORTANT**

It is recommended that bathers should limit their use of the air system to not more than 20 minutes in any one bathing session.

#### **OPERATION**

**BUTTON 1, WHITE LIGHT - POWER ON/OFF** The first button is the power button which will activate the keypad and illuminate in dim colors.

**BUTTON 2, BLUE LIGHT - BLOWER** Push the button once to activate blower, push again to turn off.

**BUTTON 3, YELLOW LIGHT - LIGHT SYSTEM** Push the button once to activate the light system. Continue to push button until desired color is reached or lights are turned off. Push and hold button for two seconds to power off immediately.

**BUTTON 4, RED LIGHT - SURFACE HEATER**

**(if equipped)** Push the button once to activate the heated seat and backrest, push again to turn off.

#### **NOTE:**

**BLOWER TIMER** - The system is equipped with a 20 minute timer. The blower will turn off automatically after the time has elapsed.

**PURGE AND DRY CYCLE** - A one minute purge and dry cycle will activate 20 minutes after the Blower is turned off. When the bather is finished, the water should be drained. The blower will reactivate 20 minutes after it is turned off and will run for one minute. The blower will turn back off after one minute.





# USE AND CARE GUIDE

## RESTORE ACR Whirlpool Bath - Model 8090 or 8190

### IMPORTANT

It is recommended that bathers should limit their use of the whirlpool to not more than 20 minutes in any one bathing session.

### OPERATION

**BUTTON 1, WHITE LIGHT - POWER ON/OFF** The first button is the power button which will activate the keypad and illuminate in dim colors.

**BUTTON 2, BLUE LIGHT - PUMP** Push the button once to activate blower, push again to turn off.

**BUTTON 3, YELLOW LIGHT - LIGHT SYSTEM** Push the button once to activate the light system. Continue to push button until desired color is reached or lights are turned off. Push and hold button for two seconds to power off immediately.

**BUTTON 4, RED LIGHT - SURFACE HEATER (if equipped)** Push the button once to activate the heated seat and backrest, push again to turn off.



## RESTORE ACR Combination - Model 8690 or 8790

### IMPORTANT

It is recommended that bathers should limit their use of the air system or whirlpool to not more than 20 minutes in any one bathing session.

### OPERATION

**BUTTON 1, WHITE LIGHT - POWER ON/OFF** The first button is the power button which will activate the keypad and illuminate in dim colors.

**BUTTON 2, BLUE LIGHT - PUMP** Push the button once to activate blower, push again to turn off.

**BUTTON 3, GREEN LIGHT - BLOWER** Push the button once to activate blower, push again to turn off.

**BUTTON 4, YELLOW LIGHT - LIGHT SYSTEM** Push the button once to activate the light system. Continue to push button until desired color is reached or lights are turned off. Push and hold button for two seconds to power off immediately.

**BUTTON 5, RED LIGHT - SURFACE HEATER (if equipped)** Push the button once to activate the heated seat and backrest, push again to turn off.

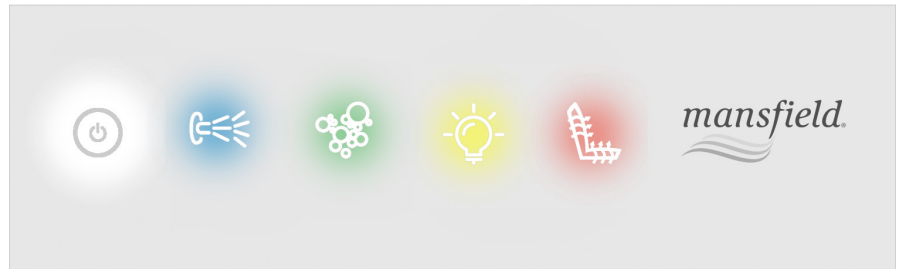

### Adjustable Jet

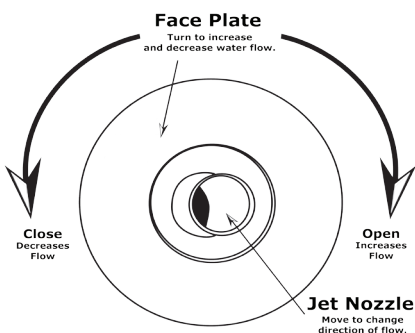

The **Adjustable Jet** can be adjusted for the optimal water flow. Turning the face plate clockwise increases water flow and counter clockwise decreases water flow.

The **Jet Nozzle** is also adjustable by moving the nozzle which changes the direction of the water flow. This allows various body areas to be targeted for a therapeutic hydro-massage.

# USE AND CARE GUIDE

## RESTORE ACR MicroDerm Therapeutic Bath - Model 8890 or 8990

See Soaking Tub section for instructions on entering, filling and exiting the bath.

### IMPORTANT

It is recommended that bathers should limit their use of the air bath to not more than 20 minutes in any one bathing session.

### OPERATION

**ON/OFF BUTTON** - Press button once to power on, press again to power off.



### NOTE:

Before activating, check prime port to ensure the system is primed. When primed, there will be no air bubbles exiting the port. System is ready to be activated.

## USER MAINTENANCE INSTRUCTIONS

### Ozonator

Whirlpools and Combination baths are equipped with Ozonators. The ozonator will emit ozone into the whirlpool piping system which will eliminate bacteria growth. It will discharge approximately twelve hours from the time it was plugged into the receptacle, and will discharge every twelve hours afterwards.

### Whirlpool and Air bath

The whirlpool and air bath systems require routine cleaning to sanitize the system. Twice per month, or more depending on usage, clean the whirlpool by following the directions below:

- Fill the tub with hot water.
- Add two (2) tablespoons of automatic dishwasher detergent and 1/2 cup of bleach to the water.
- Run whirlpool for at least 15 minutes.
- Drain, refill with cold water, operate for 10 minutes.
- Drain and wipe with a soft cloth.

### Surface cleaning

Wash all surfaces of the bathtub with a mild solution of vinegar and water. Alternately, the surface can be washed with non-abrasive household cleaners. Oily or greasy spots can be lifted with denatured alcohol. Wipe off with clear, warm water and dry with a soft cloth.

## CODE COMPLIANCE

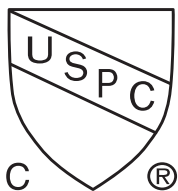

Accepted by the "Swimming Pool Research Committee" of the International Association of Plumbing and Mechanical Officials as meeting the requirements of the Uniform Swimming Pool Code.

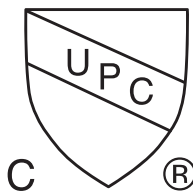

Accepted by the "Plumbing Research Committee" of the International Association of Plumbing and Mechanical Officials as meeting the requirements of the Uniform Plumbing Code.



ETL Listed (Complies with U.L. Standard 1795). Hydromassage Bathtub Listed 3129295

# WARRANTY

**Mansfield Plumbing Products**  
**Bathware Restore™ ACR Walk-in Baths**

**Residential Warranty**

Mansfield Plumbing Products, LLC offers the following expressed warranty to the original purchaser of any Restore ACR Walk-in Bath who purchases the product for personal or single family residential use ("user"). We will repair or replace, at our sole option, the product or its equipment in accordance with the following terms and conditions.

## **TEN (10) YEAR WARRANTY FOR SHELL**

Mansfield Plumbing Products, LLC extends to the user of the product a non-transferable Ten (10) year warranty from the date the product was originally purchased by the user that the shell will maintain its structural integrity and be free of water loss due to a defect in the tub shell. This warranty covers only the product shell against defects in material or workmanship.

## **FIVE (5) YEAR LABOR WARRANTY FOR ALL FACTORY INSTALLED COMPONENTS**

Our limited labor warranty is for a period of Five (5) Years from the date the product was originally purchased by the user, but not more than Six (6) years from the date of manufacture. All factory installed components (e.g., pump, motor, jets and plumbing) are covered under our labor warranty against failure due to defects in materials and workmanship.

## **WARRANTY LIMITATIONS**

In no event shall Mansfield Plumbing Products, LLC be liable for incidental or consequential damages, for damages resulting from improper installation or for damages caused by handling, neglect, abuse or alteration. Our warranty does not cover defects or damage caused by the common carrier, installer, user or other persons resulting from, without limitation: careless handling, improper voltage supply/electrical modifications, misuse; incorrect operation; lack of or improper routine maintenance; incorrect or inadequate water use or use of improper cleaners. Chips, cracks and scratches are damages and are not covered under warranty; however, they may be repaired by a qualified technician at the user's expense. Damages or defects that should have been detected before installation are not covered. All implied warranties, including any warranty of fitness for any particular purpose of merchantability, or those that might arise from a course of dealing with the purchaser or usages of trade, are hereby disclaimed or excluded.

Mansfield Plumbing Products, LLC is not responsible or liable for any delays or any failure to perform due to unforeseen circumstances or causes beyond Mansfield Plumbing Products, LLC control, when such delays or failure is due, directly or indirectly, to acts of God, war (including civil war), riots, embargoes, acts (whether sovereign or contractual) of civil or military authorities, acts of any government, major change in economic conditions, fires, floods, explosions, the elements, epidemics quarantine restrictions, strikes, lockouts, plant shutdowns, slowdowns, accidents, shortages of raw energy, materials, component parts, labor, or delays of suppliers or subcontractors.

Note: Some states do not allow limitations on an implied warranty, and some states do not allow exclusions or limitations regarding incidental or consequential damages, so the above limitations may not apply to you. This warranty gives you specific legal rights and you may have other rights which vary from state to state. No person is authorized to change, add to, or create any warranty or obligation other than set forth herein. This is our exclusive warranty.

## **RESPONSIBILITIES OF OTHERS**

Inspecting the unit prior to installation is the responsibility of the installer or building contractor who acts on behalf of the user. They are responsible for ensuring the unit is free of defect or damage. Notices are placed on and in the unit and on the shipping carton advising the installer of this responsibility. In the event of a problem, the unit must not be installed. The Company is not responsible for failures or damage that could have been discovered, repaired, or avoided by proper inspection and testing (including proper water testing) prior to installation.

Damage occurring in transit is the responsibility of the carrier. The user or installer MUST open the crate and inspect the unit for damage when it is delivered. If damage is discovered, it must be reported immediately to the seller and the carrier in writing, and an inspection requested. Failure of the carrier to respond should be reported to the seller and the carrier. Your freight claims should be filed promptly thereafter.

It is the responsibility of the installer, building contractor, or user to provide access for service. Mansfield Plumbing Products, LLC is not responsible for any costs relating to obtaining access for repair.

## **WARRANTY SERVICE**

Mansfield Plumbing Products, LLC maintains a list of independent service personnel to perform required warranty service repairs. Such firms are not agents or representatives of Mansfield Plumbing Products, LLC and cannot bind us by words or conduct. We will provide warranty service when Mansfield Plumbing Products, LLC has been notified of the problem during the active warranty period and deemed the problem to be of the nature or type covered by the warranty. The product serial number, users address and contact information must be provided to obtain warranty service.



**PRODUCT SERIAL NUMBER**

---

**CUSTOMER SERVICE**

Phone: 877.850.3060

Fax: 419.938.6234

[www.mansfieldplumbing.com](http://www.mansfieldplumbing.com)