

PRO-FIT® WHIRLPOOL & BATHTUB
3660 TFS 59 3/4" x 35 3/4" x 21 3/4"
Model number: 6119/6619 LH, 6118/6618 RH

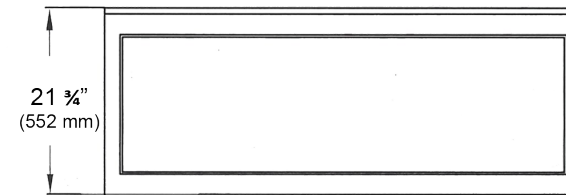

Optional Removable Access Panel
 OPENING DIMENSIONS 54" x 11"

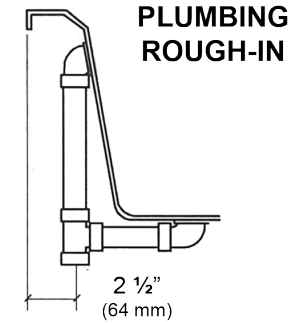
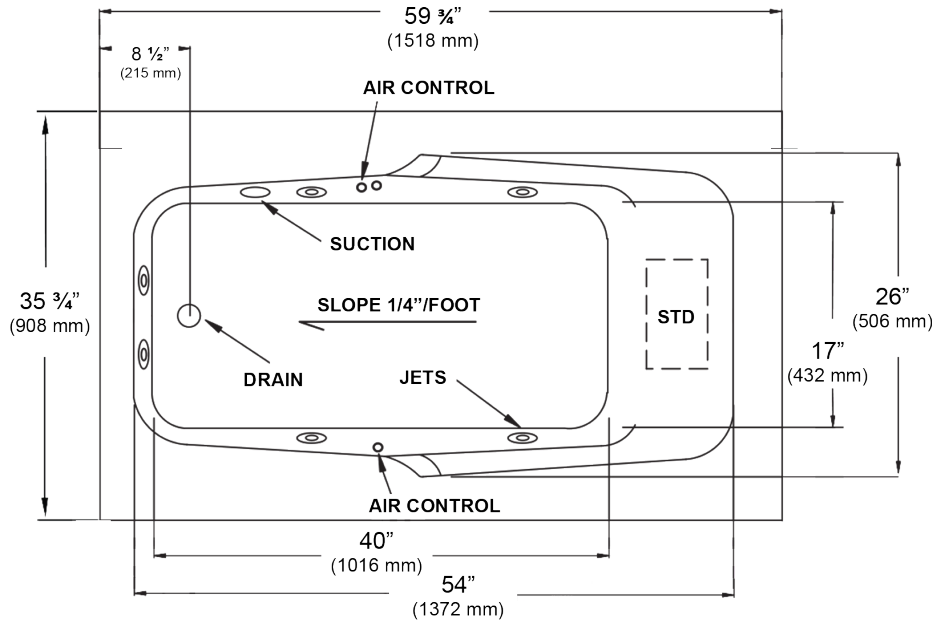
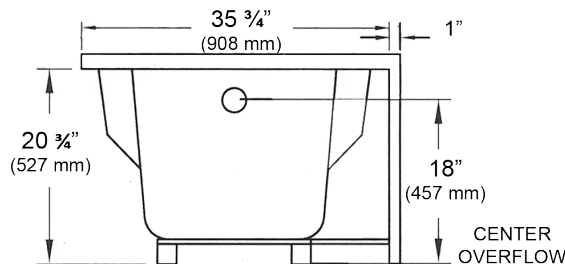

NOTES:

1. Pump location shown for clarity.
2. Required pump/motor access is 20" W x 15" H.
3. Measurements may vary 1/4" (+/-).
4. Apron is integral with optional removable access panel.
5. Removable access panel provides access to pump/motor.
6. Specify LH or RH drain when ordering.

SPECIFICATIONS:

Dimensions:	60" x 35 3/4" x 21 3/4"	Number of jets:	6
Material:	Acrylic, fiberglass reinforced	Weight:	60 lbs. (161 kg)
Pump Motor:	120 V, 60 HZ, 6.0 Amp, Single Speed, Premounted	Water Capacity:	45 gals max., 32 gals min.
Electrical Requirements:	120 V, 15 Amp, GFCI Protected	Floor Loading:	47 lbs./sq.ft. (229 kg/m ²)
On/Off Control:	Air Switch	Shipping Weight:	156 lbs. /136 lbs.